

Tetra[®] LED Systems Power Supply

(GEPS24-180U)

Power Supply Features

- Supports Tetra PowerStrip DS, Tetra miniStrip DS, Tetra EdgeStrip, Tetra Contour and Tetra Contour LS LED lighting systems
- Class 2 wiring per NEC Article 725 (SELV)
- Damp location rated
- IP66 rated: separate enclosure required

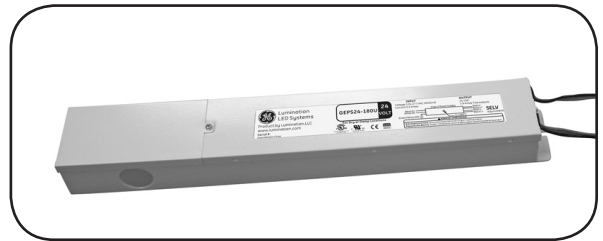

BEFORE YOU BEGIN

Read these instructions completely and carefully.

⚠ WARNING/AVERTISSEMENT

RISK OF ELECTRIC SHOCK:

- Disconnect power at fuse box or circuit breaker before servicing or installing product.
- Properly ground Tetra[®] power supply.

RISK OF FIRE:

- Use only Tetra[®] supply wire to make connection from Tetra[®] power supply to Tetra[®] LED strip.
- Use only approved wire for input/output connection. Minimum size 18 AWG (0.82 mm²)
- Follow all local codes.

RISQUES DE DÉCHARGES ÉLECTRIQUES

- Coupez l'alimentation électrique à la boîte de fusibles ou au disjoncteur avant l'entretien ou l'installation du produit.
- Assurez-vous de correctement mettre à terre l'alimentation électrique Tetra[®].

RISQUES D'INCENDIE

- N'utilisez que le fil d'approvisionnement Tetra[®] pour faire la connexion entre l'alimentation Tetra[®] et la bande DEL Tetra[®].
- N'utilisez que des fils approuvés pour les entrées/sorties de connexion. Taille minimum 18 AWG (0.82 mm²).
- Respectez tous les codes locaux.

Power Supply Installation

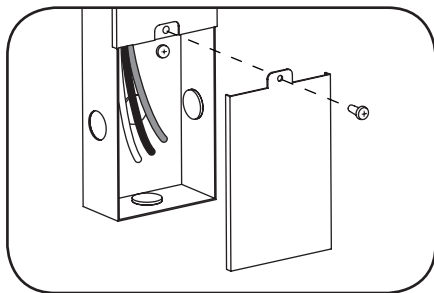

- 1** Mount LED driver and remove junction box cover. Carefully remove knockout for AC line input wires. Install appropriate electrical fittings in the knockout holes for wire protection.

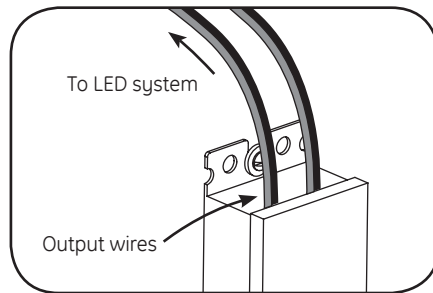

- 2** Connect the supply wire that is attached to your LED system to the red (+) and black (-) output wires of the LED driver as outlined in the "Electrical Connections" section of your LED system's Installation Instructions.

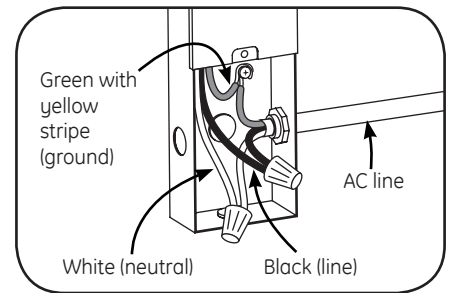

- 3** Connect the AC line to the black (line) and white (neutral) input wires of the LED driver using 18-14 AWG (0.82-2.08 mm²) twist-on wire connectors. Ground LED driver by connecting green wire with yellow stripe to grounding screw. Replace junction box cover.



NOTE: For CSA approval, a disconnect/toggle switch of appropriate rating needs to be placed within 29.5 ft. (9 m) of primary side of the power supply. The minimum rating of the switch must be either 120 or 220 Volts AC. The switch must also support twice the amount of input current.

NOTE: When installing power supply, connect to the appropriate sized building breaker or disconnect device for line and neutral connections, in accordance with local, state or country regulations.

NOTE: Exceeding maximum load will cause the power supply to shut down. Once the excess load is removed, cycle the input power to restart the power supply.

Power Supply Specifications

Performance Data	Min	Typical	Max
Input Voltage (VAC)	90	100-277	305
Input Frequency (Hz)	-	50/60	-
Input Current (A)	0.7	-	2.5
Output Voltage (VDC)	23.25	24.0	24.75
Output Current (ADC)	-	-	3.8
Output Power (W)	-	-	180
Environmental Operating Temperature Range	-40°C	+25°C	+60°C*
Environmental Humidity (non-condensing)	0%	-	95%
Environmental Storage Temperature Range	-40°C	-	+85°C
Dimensions	15.5 in. x 2.5 in. x 1.6 in. (392 mm x 62 mm x 40 mm)		

* Maximum case temperature is 80°C

Supports		Maximum Load per Power Supply	Remote Mounting Distance			
Tetra Products	SKUs		18 AWG/ 0.82 mm ²	16 AWG/ 1.31 mm ²	14 AWG/ 2.08 mm ²	12 AWG/ 3.31 mm ²
Tetra PowerStrip DS	GEWHDSPS6, GEWWDSPS6-50K, GEWWDSPS6-41K, GEWWDSPS6	14 modules/19.3 ft. (5.86 m) per bank; 28 modules/38.5 ft. (11.73 m) per PS	20 ft./6.1 m	25 ft./7.6 m	35 ft./10.6 m	40 ft./12.1 m
Tetra miniStrip DS	GEWHBDP6, GEWWBDP6-50K, GEWWBDP6-41K, GEWWBDP6	35 modules/35 ft. (10.67 m) per bank; 70 modules/70 ft. (21.34 m) per PS	20 ft./6.1 m	25 ft./7.6 m	35 ft./10.6 m	40 ft./12.1 m
Tetra EdgeStrip	GEWHBIP2, GEWWBIP2-50K, GEWWBIP2-41K, GEWWBIP2	33 modules/33 ft. (10.06 m) per bank; 66 modules/66 ft. (20.12 m) per PS	20 ft./6.1 m	25 ft./7.6 m	35 ft./10.6 m	40 ft./12.1 m
Tetra Contour LS	GEWHXNLA2-WH, GEGLXNLA2-BL, GEGLXNLA2-GL, GERDXNLA2-RD, GEWHXNAA2-WH, GEGLXNAA2-BL, GEGLXNAA2-GL, GERDXNAA2-RD,	27 ft. (8.23 m) per bank; 54 ft. (16.46 m) per PS	30 ft./9.1 m	50 ft./15.2 m	80 ft./24.4 m	120 ft./36.6 m
Tetra Contour	GEWHXNLE1, GEWWXNLE1, GEGLXNLE1, GEGLXNLE1, GERDXNLE1, GERDXNLE1, GEYAXNLE1	27 ft. (8.23 m) per bank; 54 ft. (16.46 m) per PS	30 ft./9.1 m	50 ft./15.2 m	80 ft./24.4 m	120 ft./36.6 m

This device complies with Part 15 of the FCC Rules. Operation is subject to the following two conditions: (1) this device may not cause harmful interference, and (2) this device must accept any interference received, including interference that may cause undesired operation. This Class [A] RFLD complies with the Canadian standard ICES-005. Ce DEFR de la classe [A] est conforme à la NMB-005 du Canada.

Conforms to the following standards:



GE Lighting Solutions • 1-888-MY-GE-LED • www.gelightingsolutions.com
1 - 8 8 8 - 6 9 - 4 3 - 5 3 3

GE Lighting Solutions, LLC is a subsidiary of the General Electric Company. Tetra is a trademark of GE Lighting Solutions, LLC. The GE brand and logo are trademarks of the General Electric Company. © 2012 GE Lighting Solutions, LLC. Information provided is subject to change without notice. All values are design or typical values when measured under laboratory conditions.